

### SCREW TO CONNECT DEMOLITION COUPLINGS

#### QSM & QSF, HSC SERIES

#### SCREW COUPLINGS FOR HIGH PRESSURE PULSE APPLICATIONS

#### CONNECT UNDER PRESSURE

##### INTRODUCTION

HSC Series of heavy duty, high pressure, screw couplings are designed to withstand the most severe pressure pulse applications, where other couplings suffer rapid failure.

##### ADVANTAGES

- ✓ Screw thread connection eliminates Brinelling.
- ✓ Connects and disconnects under pressure.
- ✓ Seals readily accessible for easy replacement.
- ✓ Supplied with caps and plugs to protect the thread and help prevent the ingress of contaminants.
- ✓ When connected, all internal parts are held rigid, preventing fatigue of the poppet, spring or coupling itself.
  - The poppet is guided to prevent it shifting off-centre.
  - The poppet and spring are retained by a heavy duty collet that can withstand severe forces.

##### MATERIALS

Trivalent plated carbon steel body with FKM seals and PTFE backing rings. HSC couplers are also supplied with a cap/plug.

##### SPECIFICATIONS

Operating temperatures (With FKM seals): -20°C (-4°F) to 200°C (392°F)



Performance Characteristics	Body Size						
	3/8"	1/2"	3/4"	1"	1-1/4"	1-1/2"	2"
Maximum Working Pressure (Coupled)	500 Bar	450 Bar	400 Bar	350 Bar	320 Bar	300 Bar	250 Bar
	7250 PSI	6525 PSI	5800 PSI	5075 PSI	4640 PSI	4350 PSI	3625 PSI
Burst Pressure (Coupled)	2000 Bar	1800 Bar	1600 Bar	1400 Bar	1280 Bar	1200 Bar	1000 Bar
	29000 PSI	26100 PSI	23200 PSI	20300 PSI	18560 PSI	17400 PSI	14500 PSI
Burst Pressure (Male)	2000 Bar	1800 Bar	1600 Bar	1400 Bar	1280 Bar	1200 Bar	1000 Bar
	29000 PSI	26100 PSI	23200 PSI	20300 PSI	18560 PSI	17400 PSI	14500 PSI
Burst Pressure (Female)	2000 Bar	1800 Bar	1600 Bar	1400 Bar	1280 Bar	1200 Bar	1000 Bar
	29000 PSI	26100 PSI	23200 PSI	20300 PSI	18560 PSI	17400 PSI	14500 PSI
Rated Flow	68 L/min	90 L/min	170 L/min	312 L/min	425 L/min	625 L/min	1080 L/min
	18 GPM	24 GPM	45 GPM	82 GPM	112 GPM	165 GPM	285 GPM



### Dimensions

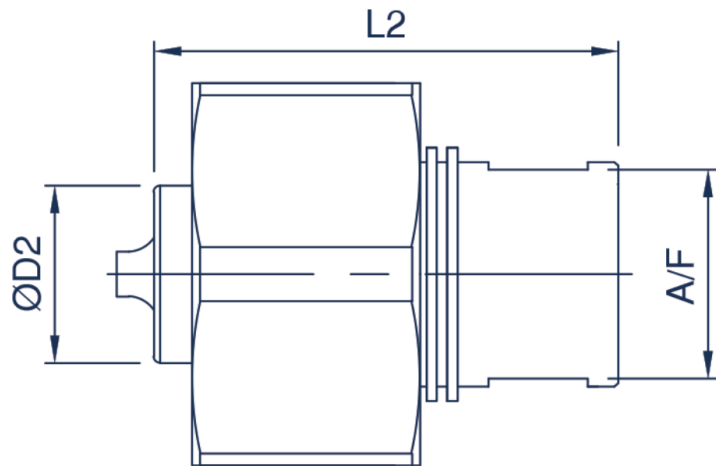

#### Male Coupler (QSM-...HSC)

Part Number	Body Size	Thread	ØD2	L2	A/F (flats)
QSM-BPF-HSC-1006*	3/8"	3/8" BSPP F	22	57	22
QSM-BPF-HSC-1208	1/2"	1/2" BSPP F	26	70	26
QSM-BPF-HSC-1912	3/4"	3/4" BSPP F	28	73	30
QSM-BPF-HSC-2516	1"	1" BSPP F	38	81.5	40
QSM-BPF-HSC-3220	1-1/4"	1-1/4" BSPP F	47	88	48
QSM-BPF-HSC-4024	1-1/2"	1-1/2" BSPP F	57	90	55
QSM-BPF-HSC-5032	2"	2" BSPP F	75	120	76

*\*3/8" size available on request*

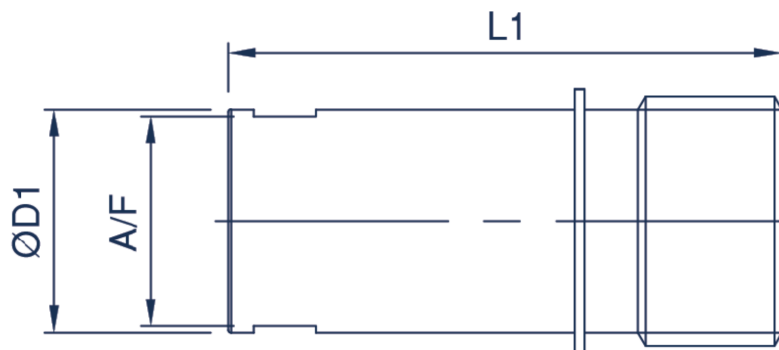

#### Female Coupler (QSF-...HSC)

Part Number	Body Size	Thread	ØD1	L1	A/F (flats)
QSF-BPF-HSC-1006*	3/8"	3/8" BSPP F	30	77	22
QSF-BPF-HSC-1208	1/2"	1/2" BSPP F	35	95	26
QSF-BPF-HSC-1912	3/4"	3/4" BSPP F	40	99.2	30
QSF-BPF-HSC-2516	1"	1" BSPP F	52.1	106	40
QSF-BPF-HSC-3220	1-1/4"	1-1/4" BSPP F	60	118	48
QSF-BPF-HSC-4024	1-1/2"	1-1/2" BSPP F	68	121	55
QSF-BPF-HSC-5032	2"	2" BSPP F	90.5	165	76

**All dimensions in mm unless otherwise stated. Dimensions shown are for guidance only, if critical contact FC staff.**

